

Courses & distances down  
Powel's Creek Beginning  
at a pine

1	S	80	W	8	perches
2	S	2	E	10	do
3	S	40 1/2	W	12	
4	S	62 1/2	W	6	
5	S	61	W	9 1/2	
6	N	61	W	7	
7	S	3 1/2	W	9	
8	S	36 1/2	W	5	
9	S	77 1/2	W	35	
10	N	86 1/2	W	14	
11	N	75 1/2	W	14	
12	N	69	W	14	
13	N	88	W	4	
14	N	69	W	15	
15	N	86	W	14	
16	N	76	W	12	
17	S	45	W	7 1/2	
18	S	67	E	11	
19	S	28	E	4	
20	S	39	E	5	
21	S	26	E	4	
22	S	24	E	4	
23	S	19	W	11	
24	S	71	W	22	
25	N	58	W	44	

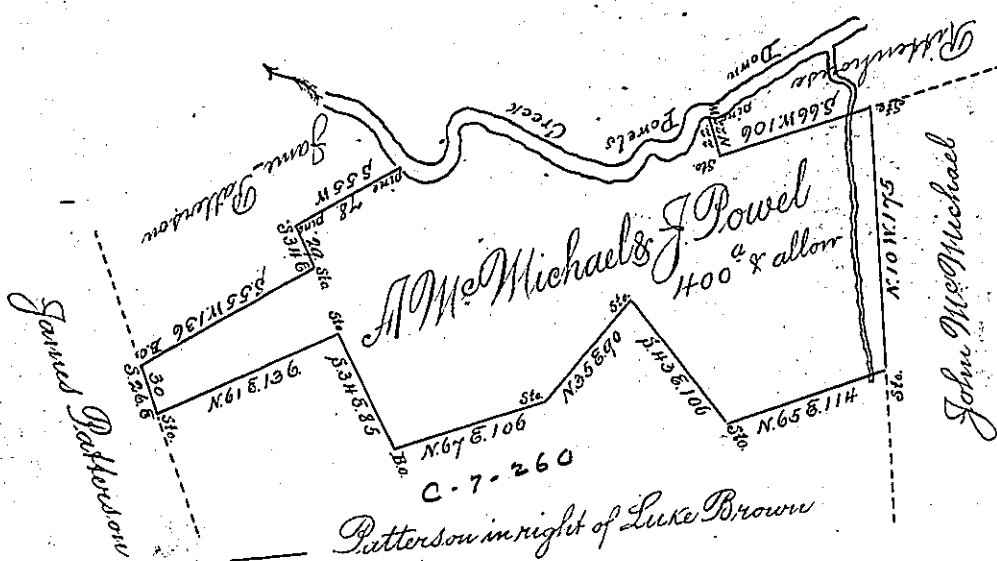

Surveyed 29<sup>th</sup> May 1828 for Archibald McMichael Junior and John Powell, by  
virtue of their Warrant of 5<sup>th</sup> June 1827, Situate in Halifax Township Dauphin County  
Containing Four hundred acres and the usual allowance of Six per Cent

John Curtis, Del.

To Gabriel Kiesler Esquire }  
Surveyor Gen<sup>l</sup> Penn<sup>a</sup> }

Notes: The above Land was first improved in the month of June Eighteen hundred and

J. Curtis, Del.

IN TESTIMONY that the above is a copy of the original remaining on file in the Department of  
Internal Affairs of Pennsylvania, made conformably to an Act of Assembly  
approved the 16th day of February, 1833, I have hereunto set my Hand  
and caused the Seal of said Department to be affixed at Harrisburg, this  
Seventh day of July 1903.

Geo. D. Brown  
Secretary of Internal Affairs.